

Single Leverage Arbor Presses

Here's the press you'll find in just about every manufacturing plant in the country. It's a Dake.

features

- **Shimmed ram cap** permits take-up for potential wear.
- **Adjustable handle** allows convenient handle positioning.
- **Smooth action gears** permit finite ram control.
- **Base opening and slotted table plate** for arbor work (models X and Y have a solid plate).
- **Pedestals** available for models Y, O and 1.



Model Y Shown

specifications

model	number	capacity	leverage ratio	ram size	maximum diameter work
		tons		inches	inches
X	01001	1	25:1	1 x1 x 7½	7
Y	01002	1½	32:1	1 x1 x12	9
00	01004	1	25:1	1 x1 x 7½	7
0	01005	1½	32:1	1 x1 x12	9
1	01006	3	36:1	1¼ x 1¼ x 16½	14

Specifications subject to change without notice.



For more information call 800-937-3253

models

X

- 1 ton capacity
- Solid table
- Friction brake

Y

- 1½ ton capacity
- Solid table
- Friction brake
- Pedestal available

00

- 1 ton capacity
- Slotted table
- Friction brake

0

- 1½ ton capacity
- Slotted table
- Friction brake
- Pedestal available

1

- 3 ton capacity
- Slotted table
- Friction brake
- Pedestal available

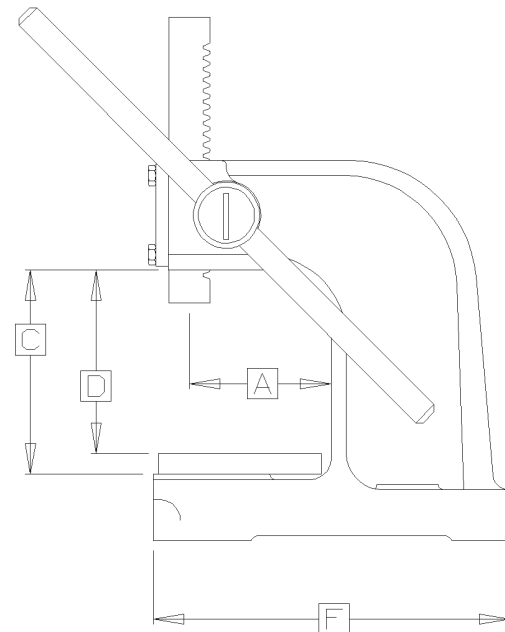
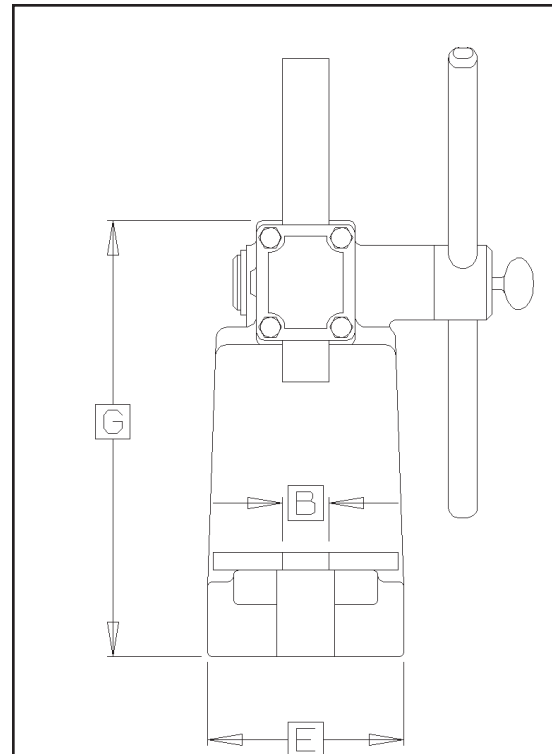

A	B	C	D	E x F	G	
throat	largest arbor	maximum ram to table	maximum ram to table plate	base	height	weight
inches	inches	inches	inches	inches	inches	pounds
3½		4½		4¼ x 9½	9	25
4½		7¾		6 x 15	14½	60
3½	1	5	4½	4¼ x 9	9¾	25
4½	1	7¾	7⅛	6 x 14	14½	65
7	2	11½	10¾	7¼ x 18	19	130

pedestal specifications			
part number	base	height	weight
	inches	inches	pounds
01003	10 x 18	36	50
01003	10 x 18	36	50
01007	12 x 21	36	70

Ratchet Lever Arbor Presses

Designed to work the way it's most comfortable for you.

features

■ **Ratchet device** permits lever to be used in most convenient position.

■ **Handwheel** advances ram to work quickly.

■ **Counterweight** returns lever quickly after downstroke.

■ **Pedestals** available for models 1½, 1½B and 3A.



Model 1¾ Shown



Model 1½ C Shown



Model 1½ B Shown

specifications

model	number	capacity	leverage ratio	ram size	maximum diameter work
				tons	inches
1½	02001	3	48:1	1¼ x 1¼ x 16½	14
1½B	02002	3	48:1	1¼ x 1¼ x 24½	14
1½C	02003	3	48:1	1¼ x 1¼ x 24¼	35
1¾	02007	3	48:1	1¼ x 1¼ x 16½	14
3A	02004	5	55:1	2 x 2 x 23	20
4M	02006	5	55:1	2 x 2 x 23	20

Specifications subject to change without notice.



For more information call 800-937-3253

models

1½

- 3 ton capacity
- Fixed table
- Friction brake
- Bench model
- Pedestal available

1½B

- 3 ton capacity
- Fixed table
- Designed for broaching
- Friction brake
- Bench model
- Pedestal available

1½C

- 3 ton capacity
- Fixed table
- Designed for large diameter work pieces
- Bench model

1¾

- 3 ton capacity
- Fixed table
- Friction brake
- Side-mount model for hydraulic press

3A

- 5 ton capacity
- Fixed table
- Hand-operated brake
- Bench model
- Pedestal available

4M

- 5 ton capacity
- Adjustable table
- Mandrel catcher on base
- Hand-operated brake
- Floor model

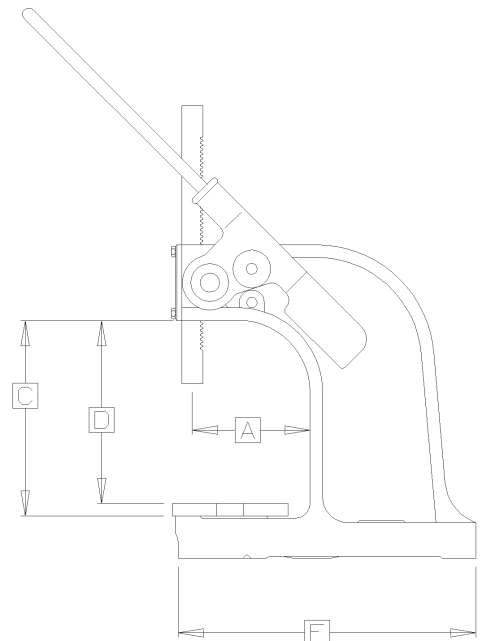
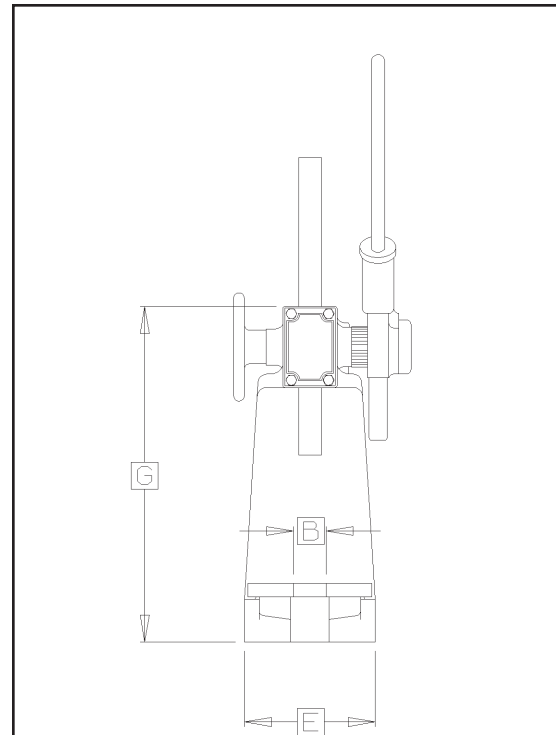

							pedestal specifications			
A	B	C	D	E x F	G		part number	base	height	weight
throat	largest arbor	capacity over table	capacity over table plate	base	height	weight				
inches	inches	inches	inches	inches	inches	pounds		inches	inches	pounds
7	2	11½	10¾	7¼ x 18	19	145	01007	12 x 21	36	70
7	2	18¼	17½	8¼ x 21	28	196	03002	18 x 24	33	125
17½	2	12	11¼	8¼ x 37¼	24¾	425				
7	2	11½	10¾		18½	125				
10	4	16	14½	10 x 24	28½	450	02005	18 x 28½	33	150
10	5¼	26	24½	21½ x 29	58	1045				

Compound Leverage Arbor Presses

Steps up the pressure for heavier press work.

features

- **Compound leverage mechanism** allows greater pressure application with minimum effort.
- **Sliding pin** easily converts press from compound to single leverage.
- **Rack and pinion table adjustment** on model 4.
- **Dual swinging tables** for height adjustment on model 5.
- **Pedestals** available on all bench models.



Model 4 Shown

specifications

model	number	capacity	leverage ratio	ram size	maximum work diameter
		tons		inches	inches
2	03004	6	66:1	1½ x 1½ x 19	15½
2B	03001	6	66:1	1½ x 1½ x 19	15½
2½	03003	6	66:1	1½ x 1½ x 27	15½
3	03005	12	112:1	2 x 2 x 24	20
4	03007	12	112:1	2 x 2 x 24	20
5	03008	15	150:1	2 x 2 x 24	24½

Specifications subject to change without notice.



For more information call 800-937-3253

models

2

- 6 ton capacity
- Fixed table
- Hand-operated brake
- Bench model
- Pedestal available

2B

- 6 ton capacity
- Fixed table
- Large arbor designed for electrical and generator work
- Hand-operated brake
- Bench model
- Pedestal available

2½

- 6 ton capacity
- Fixed table
- Designed for broaching
- Hand-operated brake
- Bench model
- Pedestal available

3

- 12 ton capacity
- Fixed table
- Hand-operated brake
- Bench model
- Pedestal available

4

- 12 ton capacity
- Adjustable table
- Hand-operated brake
- Floor model

5

- 15 ton capacity
- Two swinging tables
- Hand-operated brake
- Floor model

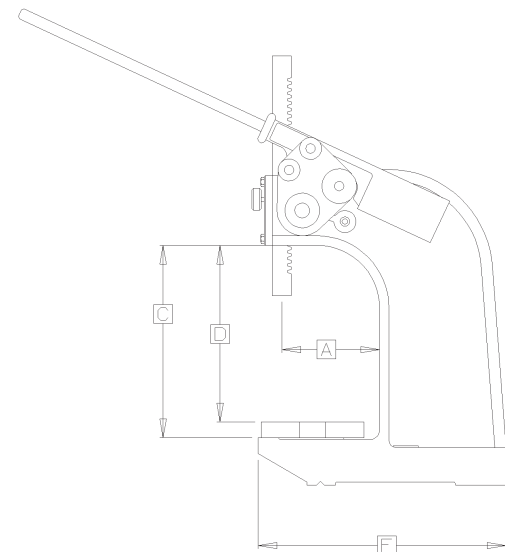
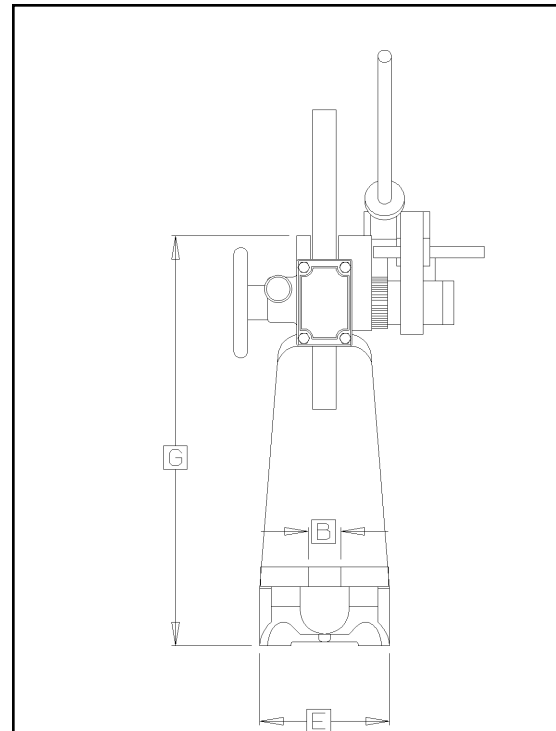

							pedestal specifications				
A	B	C	D	E x F	G			part number	base	height	weight
throat	largest arbor	maximum ram to table	maximum ram to table plate	base	height	weight			inches	inches	pounds
inches	inches	inches	inches	inches	inches	pounds			inches	inches	pounds
7¾	3	15	13¾	8¼ x 20	26	260	03002	18 x 24	33	125	
7¾	5½	15	14	8¼ x 20	26	280	03002	18 x 24	33	125	
7¾	3	21½	20¼	8¼ x 20	32½	315	03002	18 x 24	33	125	
10	5¼	19	17¼	13 x 25½	35½	640	03006	21 x 30	27½	180	
10	5¼	26	24½	21½ x 37	62	1,350					
12¼	5½	46	16	27 x 32½	64½	1,800					

Air-Operated Bench Presses

Look for these two essential features in any bench press—a cast iron frame and a quality air cylinder. **Dake's got 'em.**

features

- **Non-rotating double acting ram** eliminates guide pins on most tooling.
- **Chrome-plated piston rod** resists rust and ensures long life.
- **Threaded rod end** permits nose piece and tooling to be easily attached and detached.
- **Easily adjusted** ram speed, pressure, and stroke allow accurate control of ram movement.
- **Dual-palm push buttons** must be engaged before the ram will move and cannot be mechanically by-passed.
- **Polyurethane rod wiper** protects cylinders from dust and contaminants.
- **Air filter/regulator** combination assembly ensures clean and continuous air flow to press.
- **Daylight** can be increased with ease.

Note: Press is shown without point of operation guarding. Guarding is required for safe operation—See ANSI B 11.2 bulletin.



Model 1-210 Shown

specifications

model	number	capacity	air pressure	ram travel	weight
		pounds	psi	inches	pounds
1-204	01204	400	90	2	70
1-210	01210	1,000	85	4	110
1-220	01220	2,000	100	4	195

Specifications subject to change without notice.



For more information call 800-937-3253

models

1-204

■ 400 pound capacity

1-210

■ 1,000 pound capacity

1-220

■ 2,000 pound capacity

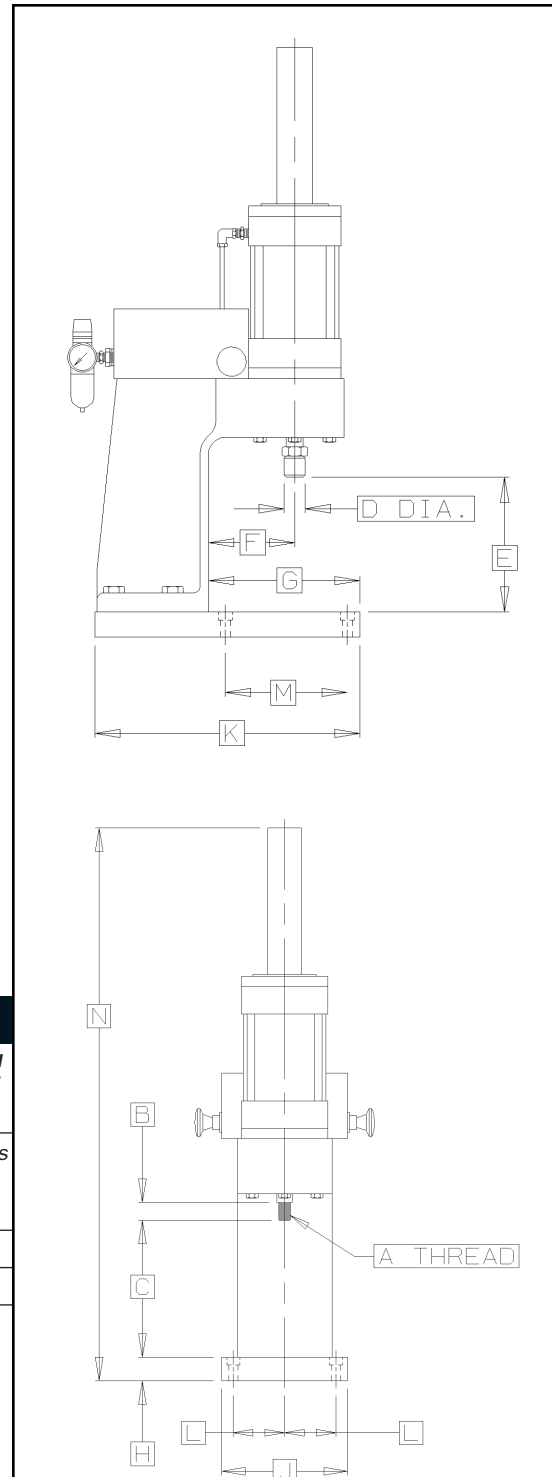

A	B	C	D	E	F	G x J	H	K x J	M x L	N
thread	length of thread	daylight without nose piece	nose piece diameter	daylight with nose piece	throat	work area	plate thickness	base	hole pattern	overall height
inches	inches	inches	inches	inches	inches	inches	inches	inches	inches	inches
1/2-20	3/4	5 11/16	1	5	5	9x6	1	13 3/8 x 6	7 1/4 x 1 3/4	23
3/4-16	1 1/8	8 11/16	1 1/4	8	5	9x8	1 1/4	14 9/16 x 8	7 1/4 x 3 1/4	34
3/4-16	1 1/8	8 11/16	1 1/4	8	5	9x8	1 1/2	15 3/4 x 8	7 1/4 x 3 1/4	35

C-frame Bench Presses

High speed, low cost, and ready for any press work you can imagine.

features

■ **Adjustable return stroke**, activated by proximity switch, permits accurate control of ram movement.

■ **Remote pressure adjustment** easily sets maximum pressure desired.

■ **Light-sensitive thumb pads** must be engaged simultaneously before ram will move and cannot be mechanically by-passed.

■ **Run-jog selector** allows fast, easy job set-up.

■ **Hydraulic cylinders** are manufactured to withstand 3000 psi, but are used at less than 2000 psi to prolong service life.

models

28-604

■ 4 ton capacity

28-608

■ 8 ton capacity

28-612

■ 12 ton capacity

Note: Press is shown without point of operation guarding. Guarding is required for safe operation—See ANSI B 11.2 bulletin.



Model 28-608 Shown

specifications

model	capacity	horsepower	rpm	ram speed			ram thread dimensions
				inches per minute			
	tons			advance	press	return	
28-604	4	1	1,800	510	62	475	1"-14 x 1¼ deep
28-608	8	2	1,800	481	39	447	1½"-12 x 1¾ deep
28-612	12	5	1,800	511	62	474	1⅞"-12 x 1¾ deep

Specifications subject to change without notice.



For more information call 800-937-3253

standard equipment

For each press ordered, select the bolster, nose piece, and desired voltage that meet your needs.

- **Bolsters** can easily be removed and replaced for different jobs. Select one for each press ordered. Additional bolsters are available as optional equipment.
 1. Plain bolster
 2. Bolster with U-slot
 3. Bolster with bored hole

- **Nose pieces** available. Select one.
 1. Threaded nose piece
 2. Flanged nose piece
- **Voltages** available. Select one.
 1. 208 volts, 3 phase
 2. 230 volts, 3 phase
 3. 460 volts, 3 phase
 4. 575 volts, 3 phase

optional equipment

- Pedestals
- Air/oil heat exchanger
- Pressure reversal control
- Distance reversal control
- Variable speed control
- External dwell timer
- Piece/cycle counter

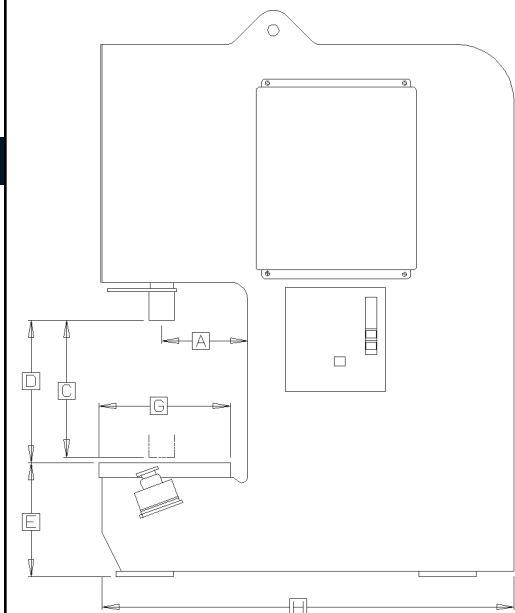
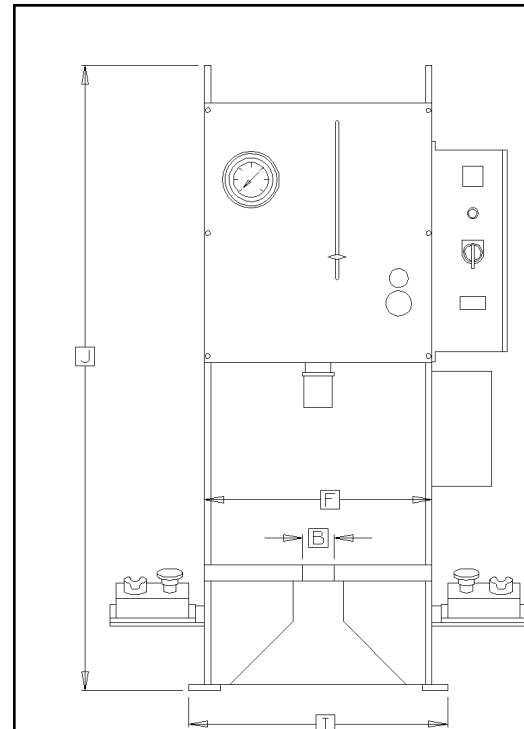

A	B	C	D	E	F x G	H x I	J	
throat	table slot width	ram travel	maximum ram to table	table to base	table	base	height	weight
inches	inches	inches	inches	inches	inches	inches	inches	pounds
7½	2½	12	12½	10	18x11½	31 x19¾	49¼	1,229
7½	2½	12	12½	10	18x11½	36 x20½	50	1,355
10½	7	12	14½	12	23x19	47½x24¾	58⅝	2,460

Laboratory Presses

For compression molding, laminating, testing and more.

features

■ **Electric platens:** The self-leveling, electrically heated, water cooled, precision ground steel platens are pre-wired into the control panel. Heating elements are replaceable.

■ **Precise temperature control:** Each platen has its own complete set of controls including adjustable theroswitch, built-in thermometer, power switch and pilot light. Temperatures are accurately controlled from 100° to 600°F.

■ **Hydraulic system:** A unique pump design provides a rapid advance of the ram utilizing the high volume-low pressure portion of the pump. When the down stroke of the pump lever is used, the pump automatically converts to the high pressure-low volume output providing accurate control and easy operation. The carefully constructed hydraulic system enables the press to hold pressure for extra long periods of time. The release valve on the side of the press enables the operator to adjust the pressure accurately as well as accomplish gradual decompression or fast opening of the press.



Model 44-225 Shown

specifications

model	tonnage	max. temp F	watts per press	voltage single phase	amps	number of openings
		degrees		volts		
44-225	25	600	2,900	120*	25	1
44-226	25	600	3,600	120*	30	1
44-250	50	600	4,800	240**	20	1
44-251	50	600	7,200	240**	30	1
44-275	75	600	10,800	240**	26	1

*240 Volts also available. **480 Volts also available.

Specifications subject to change without notice.



For more information call 800-937-3253

features

continued

■ Two position ram:

A removable adaptor is placed between the self-leveling platen and the ram. By removing the adaptor, a greater daylight dimension is available.

■ Control panel:

A conveniently located panel at the top of the press is isolated from the press and is cooled by an air space between the housing and the upper platen. All electricals are mounted on a common plaque for easy servicing.

models

44-225

44-226

44-250

44-251

44-275

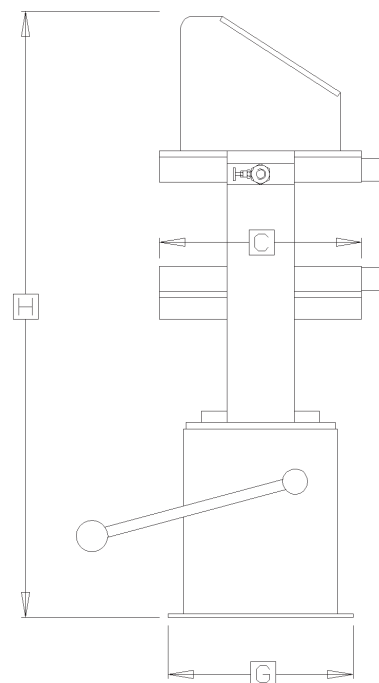
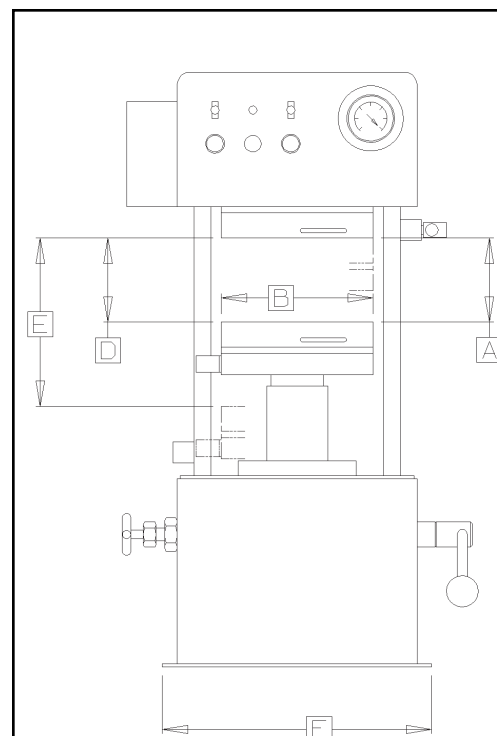

A	B x C	D	E	F x G	H	
<i>stroke</i>	<i>platens</i>	<i>daylight between each platen with adaptor</i>	<i>daylight between each platen without adaptor</i>	<i>base dimension</i>	<i>overall height</i>	<i>weight</i>
<i>inches</i>	<i>inches</i>	<i>inches</i>	<i>inches</i>	<i>inches</i>	<i>inches</i>	<i>pounds</i>
5	9x9	5	10	16x11	36	425
5	9x12	5	10	16x11	36	450
6	12½ x 12½	6	10	18x16	39	825
6	12½ x 19	6	10	18x16	39	925
6	19x19	6	12	26x21	51	1,900

Drill Presses

Modern design with the operator in mind.

features

■ **A locking handle hub** with convenient dial-in adjustment and an easy to read scale for fast, accurate, and repeatable depth setting changes.

■ **CE safety electrical package features** push button on/off switch, emergency stop button, low voltage controls, thermal overload, and interlock safety switch for belt cover.

■ **Large diameter sturdy spindle** for rigid drilling has four bearing points for smooth operation.

■ **Massive cast head, machined column, and sturdy cast base** reduces vibration.

■ **Bench and floor models** both have machined table and base surfaces with t-slots for mounting and fixturing

■ **Quick bit changes** with standard Morse Taper (MT), common adaptors or standard keyed chuck.

■ **Quick release belt tensioning** for fast, easy speed changes.

■ **Handle has 3 spokes** with spring return for precise operator control and ergonomic operation.



TB-16 Shown

SB-25 Shown

specifications

model	part #	drill capacity	motor HP	spindle taper	working diameter	no. of speeds	spindle speed range	electrics	weight
TB-16	77100	5/8"	1/2	MT2	14 1/8"	9	240-3400	CE 120V 1ph	175
SB-16	77200	5/8"	1/2	MT2	14 1/8"	9	240-3400	CE 120V 1ph	230
SB-25	77300	1"	1	MT3	18"	9	270-2000	CE 220V* 3ph	397
SB-25 1PH	77500	1"	1	MT3	18"	9	270-2000	CE 220V 1ph	397
SB-25 1PH	77600	1"	1	MT3	18"	9	270-2000	CE 110V 1ph	397
SB-32	77400	1 1/4"	2	MT4	18"	9	270-2290	CE 220V* 3ph	483

*Please specify voltage when ordering (220V/440V).

Specifications subject to change without notice.



For more information call 800-937-3253

standard equipment

- Keyless chuck
 - 1/2" on TB-16 & SB-16
 - 5/8" on SB-25 & SB-32
- Plexiglas chip & chuck guard
- Drift (for bit removal)

models

TB-16
SB-16
SB-25
SB-32

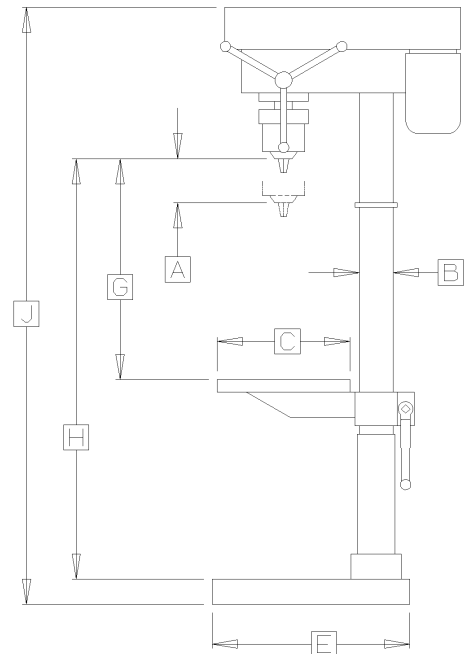
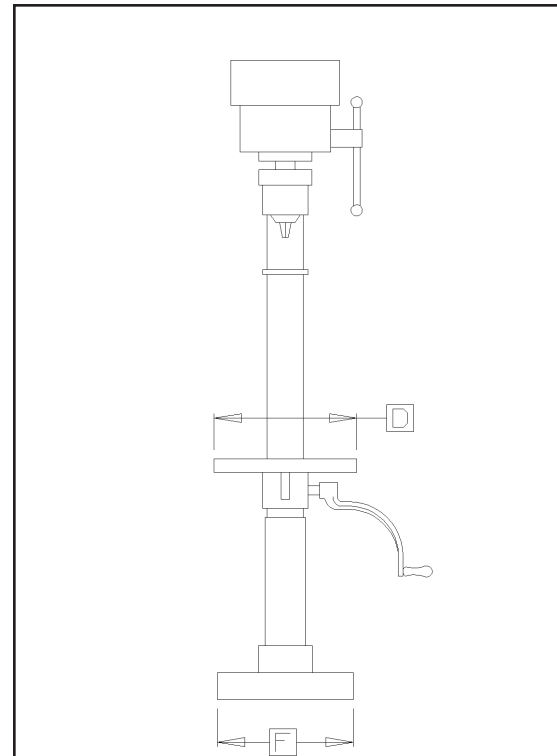

A	B	C	D	E	F	G	H	J
spindle travel	column diameter	table depth	table width	base depth	base width	spindle to table	spindle to base	overall height
3 1/8"	3 1/8"	11 3/4"	11 3/4"	17 3/4"	12 1/4"	16 1/2"	26 1/2"	42 1/2"
3 1/8"	3 1/8"	11 3/4"	11 3/4"	19 5/8"	12 1/2"	28 1/2"	49 1/4"	64"
5"	3 5/8"	13 3/4"	13 3/4"	23 5/8"	15"	28 3/8"	49 1/4"	71"
5"	3 5/8"	13 3/4"	13 3/4"	23 5/8"	15"	28 3/8"	49 1/4"	71"
5"	3 5/8"	13 3/4"	13 3/4"	23 5/8"	15"	28 3/8"	49 1/4"	71"
5 1/2"	4"	15 3/4"	15 3/4"	23 5/8"	15"	26 3/8"	50"	71"

Belt Grinder

6,600 fpm grinding speed for maximum grinding efficiency.

features

- **Pivots** up and down on base for easy, ergonomic work height adjustments.
- **Hinged top cover** opens for access to grind large pieces using the entire length of the belt.
- **Advanced belt tracking** with vented front wheel fixed in place for rigidity when grinding on the wheel radius.
- **Enclosed frame** reduces dust with side access to wheels for quick belt changes.
- **Adjustable parts rest** and backing plate with Plexiglas shield to keep the part being ground steady and in place.

models

- **G-75 1PH**
Single phase, 220 volts
- **G-75**
Three phase, 220/440 volts

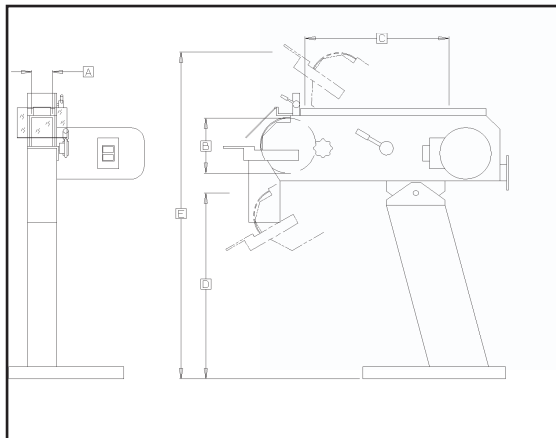

specifications

model	part #	belt size	horse power	electrics	A x B contact wheel size	belt speed	C grinding plane (full)	D min. plane	E max. plane	weight pounds
G-75 1PH	61002	3"x79"	4	220V 1ph	3"x8"	6,600 fpm	3"x21"	27"	47"	250
G-75	61001	3"x79"	4	220/440V 3ph	3"x8"	6,600 fpm	3"x21"	27"	47"	250

Specifications subject to change without notice.

Foot Vise

Frees up both hands to hold the work piece.



For more information call 800-937-3253

features

- **Foot activation** clamps the work piece firmly in place while freeing up both of the operators hands.
- **Push button jaw changes.** Just push in the button to insert or remove jaws. Then tighten with a hex key.
- **Adjustable pedal height** for ergonomic operation.
- **Heavy cast vise components** for repetitive use in production applications and manufacturing cells.
- **Valuable tool** makes difficult clamping problems easy for one-man operations.

- **Gibbed jaws** for long wear and adjustment.

standard jaws

- **Smooth jaws**
- **Aluminum jaws**
- **Prism jaws (for tubes)**

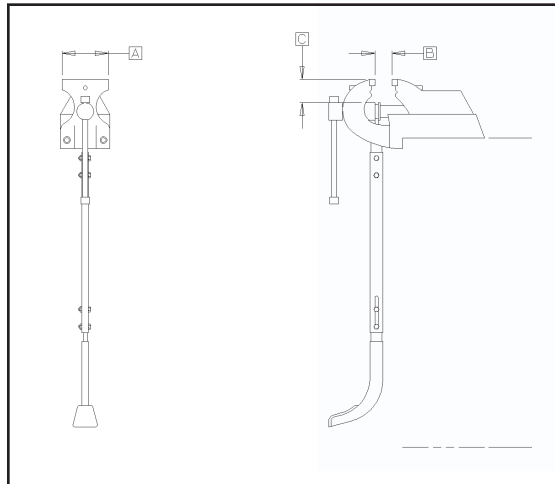

specifications

model	part #	A jaw width inches	B max. opening inches	C throat depth inches	D min. table to floor inches	weight pounds
FV135	301765	5 ⁵ / ₁₆	7 ⁷ / ₈	2 ³ / ₄	36	97